

1. Remove nut from carburetor mounting stud.

2. Place Throttle Cable Bracket over stud and reinstall nut.

3. Use tightening screw to stabilize bracket against base of carburetor.

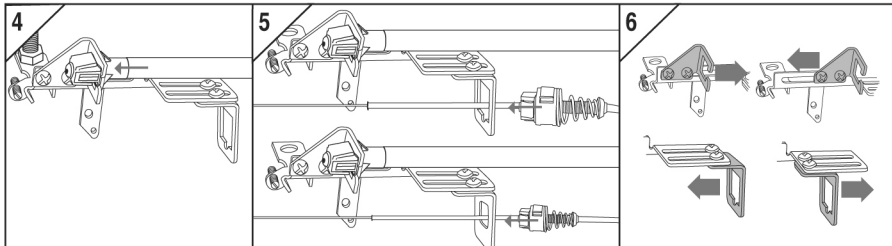

4. Install throttle cable into the Throttle Cable Bracket.

5. If necessary install the kickdown cable into the kickdown bracket (using the appropriate bracket for your application).

6. Adjust the brackets to the appropriate tension level. After adjusting, check the throttle cable to make sure the cable allows throttle to close completely when released and open fully when gas pedal is depressed completely.